

GRUPO 12 12 PANEL DE INSTRUME

GROUP 12 12 INSTRUMENT PANEL

GROUP 12 12 PANNEAUX ET INDIC  
-----

COMPOSICION.....COMPOSITION.....COMPOSICION  
-----

| DENOMINACION         | DESCRIPTION          | DENOMINATION         | HOJA<br>PAGE<br>PAGE |
|----------------------|----------------------|----------------------|----------------------|
| PANEL DE INSTRUMENTO | INSTRUMENT PANEL     | PANNEAUX ET INDICATE | 310                  |
| PANEL DE INST 88 LIG | INSTRUMENT PA 88 LIG | PANNEAUX ET I 88 LIG | 312                  |

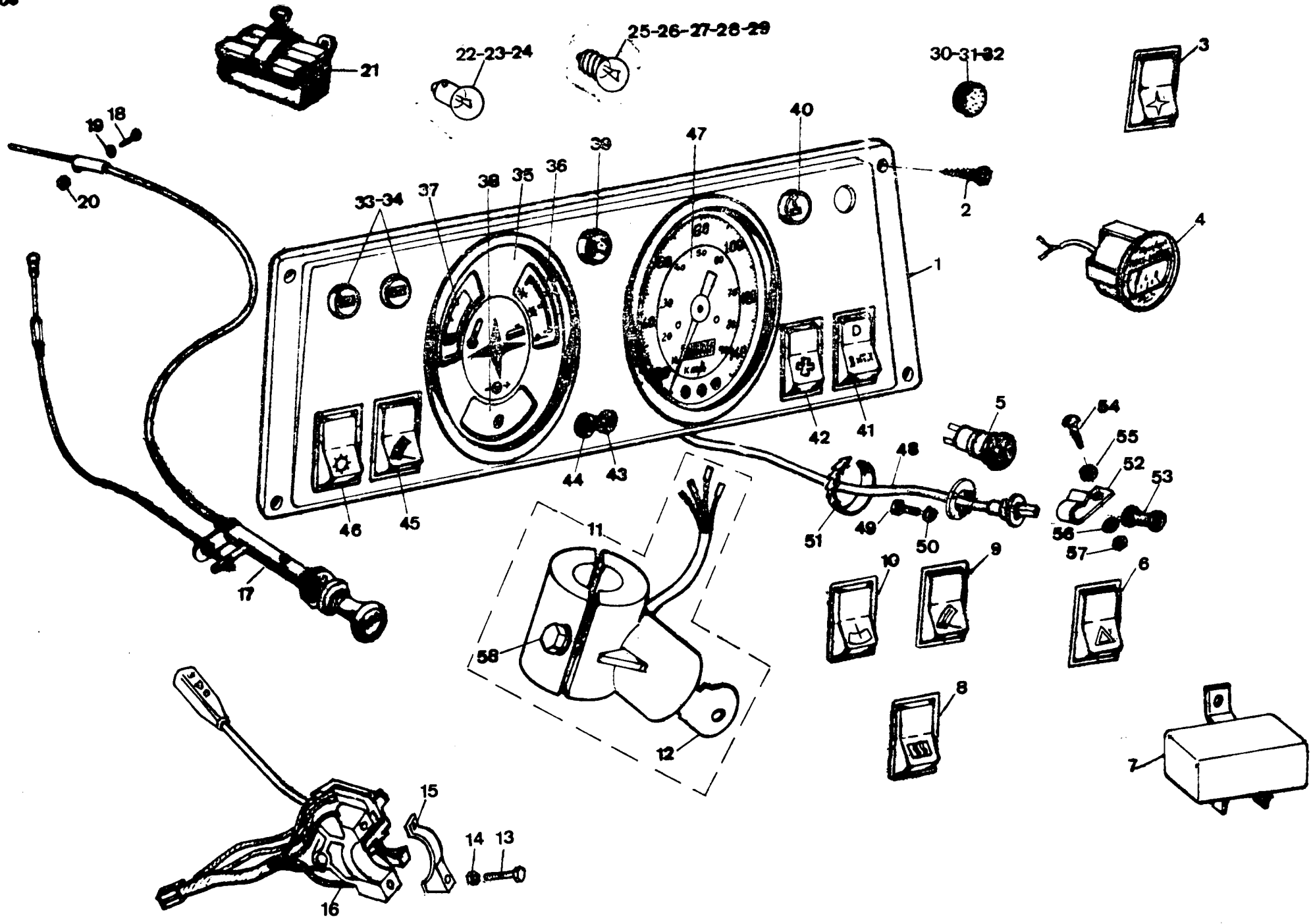

PUBLICACION N 20313  
EDICION N 1

GRUPO=17 PANEL DE INSTRUMENTO  
GROUP=17 INSTRUMENT PANEL  
GRUPE=17 PANNEAUX ET INDIC

SUBGRUPO=PAÑEL DE INSTRUMENTO  
SUBGROUP=INSTRUMENT PANEL  
SUBGRUPE=PANNEAUX ET INDICATE

| N.FIG | N.PILTA    | CAN |                       |                       |                       |             |
|-------|------------|-----|-----------------------|-----------------------|-----------------------|-------------|
| PLATE | PARINUMBER | QTY |                       |                       |                       |             |
| N.FIG | N.PIECE    | OUT | DENOMINACION          | DESCRIPTION           | DENOMINACION          | C H A S I S |
| 1     | 202950     | 1   | PANEL DE INSTRUMENTO  | INSTRUMENT PANEL      | PANNEAU D INSTRUMENT  |             |
| 2     | 184264     | 4   | TORNILLO              | SCREW                 | VIS                   |             |
| 3     | 163531     | 1   | TAPON 4C              | PLUG 4C               | BOUCHON 4C            |             |
| 4     | 589137F1   | 1   | INDICADOR PRESION AC  | OIL PRESRE INDICATO   | INDIC PRESION D HUIL  |             |
| 5     | 161508     | 1   | LUZ CONTROL CALENTAD  | HEATER LIGTH          | LUMIERE COMPTEUR CHA  |             |
| 6     | 166571     | 1   | LUZ AVISO AVERIA      | WARNING               | LUMIERE AVERT AVARIE  |             |
| 7     | 166571     | 1   | RELE DE LUCES EMERGE  | WARNING RELAY         | RELE CLIGNOTEUR EMER  |             |
| 8     | 165514     | 1   | INTERRUP LUNETA TERM  | GLASS CALOPIF SWITCH  | INTERRUP DE LUNETE    |             |
| 9     | 165515     | 1   | INTERRUP LIMPIA TRAS  | REAR WIPER MOTOR SWI  | INTERRUP DE ESSU ARR  |             |
| 10    | 162551     | 1   | INTERR LAVAPAR TRASE  | REAR WASHER SWITCH    | INTERR ESSUI GLA AR   |             |
| 11    | 166531     | 1   | LLAVE DE ARRANQUE D   | IGNITION KEY D        | CLE DE COMMUTATEUR D  |             |
|       | 166532     | 1   | LLAVE DE ARRANQUE G   | IGNITION KEY P        | CLE DE COMMUTATEUR E  |             |
| 12    | 194312     | S-N | LLAVE EN BRUTO        | KEY BLANK             | CLEF RUSTIQUE         |             |
| 13    | 186130     | 2   | TORNILLO              | SCREW                 | VIS                   |             |
| 14    | 313484     | 2   | TUERCA                | NUT                   | ECROU                 |             |
| 15    | 161119     | 1   | BRIDA                 | FLANGE                | BRIDE                 |             |
| 16    | 575383K1   | 1   | MANDO DE LUCES        | SWITCH FOR FLASHER    | INTERRUPTEUR DE LUMI  |             |
| 17    | 164675     | 1   | ESTRANSULADOR G       | STARTING SHUTLER P    | VALET DE DEPART E     |             |
|       | 165607     | 1   | CABLE DE PARE 6C D    | STOP CABLE 6C D       | CABLE D ARRET 6C D    |             |
|       | 165603     | 1   | CABLE DE PARE 4C D    | STOP CABLE 4C D       | CLABE D ARRET 4C D    |             |
| 18    | 250962     | 1   | TORNILLO              | SCREW                 | VIS                   |             |
| 19    | 3173       | 1   | ARANDELA              | WASHER                | RONDELLE              |             |
| 20    | 2247       | 1   | TUERCA                | NUT                   | ECROU                 |             |
| 21    | 563318     | 1   | INTERRUPTOR G         | SWITCH P              | INTERRUPTEUR E        |             |
| 22    | 161278     | 4   | BOMBILLA 3w.109SUP D. | LAMP 3 w. 109 SUP. D. | LAMPE 3 w. 109 SUP D. |             |
| 23    | 161278     | 2   | BOMBILLA 3w. 4c. 6c.  | LAMP 3 w. 4c. 6c.     | LAMPE 3 w. 4c. 6c.    |             |
| 24    | 161278     | 3   | BOMBILLA 3w. 88SUP D  | LAMP 3ww. 88 SUP D.   | LAMPE 3 w. 88 SUP D.  |             |
| 25    | 164837     | 5   | BOMB 24V 3W CAZO 4CD  | LAMP 24V 3W CAZO 4CD  | LAMPE 24V 3W CAZ 4CD  |             |
| 26    | 232591E1   | 1   | BOMB 3W CAZORLA       | LAMP 3W CAZORLA       | LAMPE 3W CAZORLA      |             |
| 27    | 232591E1   | 6   | BOMB 3W 6CPD 4CP      | LAMP 3W 6CPD 4CP      | LAMPE 3W 6CED 4CE     |             |
| 28    | 232591E1   | 5   | BOMB 3W 4C D          | LAMP 3W 4C D          | LAMPE 3W 4C D         |             |
| 29    | 160559     | 1   | BOMB 6V 2 2W 4C D     | LAMP 6V 2 2W 4CD      | LAMPE 6V 2 2W 4CD     |             |
| 30    | 165551     | 2   | TAPON 4C D            | PLUG 4C D             | BOUCHON 4C D          |             |
| 31    | 165551     | 3   | TAPON G               | PLUG P                | BOUCHON E             |             |

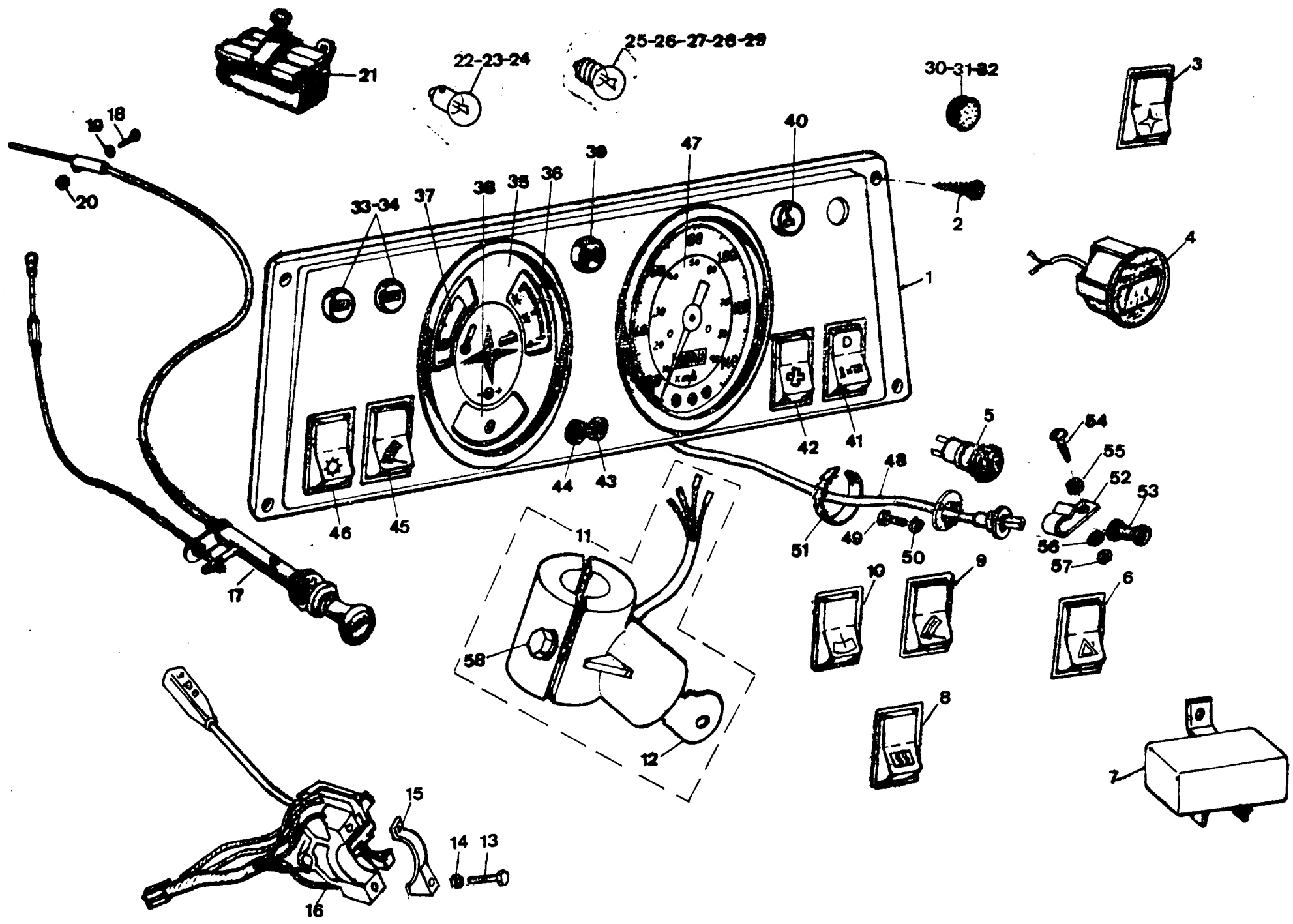

PUBLICACION N 880013  
EDICION N 1

GRUPO=12 PANEL DE INSTRUME  
GROUP=12 INSTRUMENT PANEL  
GROUPE=12 PANNEAUX ET INDIC

SUBGRUPO=PANEL DE INSTRUMENTO  
SUBGROUP=INSTRUMENT PANEL  
SUBGROUPE=PANNEAUX ET INDICATE

| N.FIG | N.PIEZA    | CAN | DENOMINACION         | DESCRIPTION          | DENOMINATION         | C H A S I S |
|-------|------------|-----|----------------------|----------------------|----------------------|-------------|
| PLATE | PARTNUMBER | QTY |                      |                      |                      |             |
| N.FIG | N.PIECE    | OUT |                      |                      |                      |             |
| 32    | 165550     | 1   | TAPON 6C D           | PLUG 6C D            | BOUCHON 6C D         |             |
| 33    | 718110     | 1   | INDICADOR DEPOSITO4C | FUEL TANK INDICAT04C | INDICATEUR RESERVO4C |             |
| 34    | 718110     | 2   | INDICADOR DEPOSITO6C | FUEL TANK INDICAT06C | INDICATEUR RESERVO6C |             |
| 35    | 161572     | 1   | PANEL COMBINADO      | GANGE PANEL          | TABLIER COMPLETE     |             |
| 36    | 555835K1   | 1   | INDICADOR COMBUSTIBL | FUEL GANGE INDICATOR | INDICATEUR DE CARBUR |             |
| 37    | 193344     | 1   | INDICADOR TEMPERATUR | TEMPERATURE GANGE    | INDICATEUR DE TEMPER |             |
| 38    | 555837     | 1   | INDICADOR CARGA      | WARNING LIGTH CHARGE | INDICATEUR DE CHARGE |             |
| 39    | 718363     | 1   | INDICADOR INTERMITEN | DIRECTION INDICATOR  | INDICATEUR DIRECTION |             |
| 40    | 718109     | 1   | INDICADOR FRENOS     | BRAKES INDICATOR     | INDICATEUR DE FREINS |             |
| 41    | 163530     | 1   | INTERRUP DOBLE DEPOS | DOUBLE FUEL TANK SWI | INTERRUP DOUBLE RESE |             |
| 42    | 712093     | 1   | INTERRUPTOR CALEFACC | HEATING SWITCH       | INTERRUP DE CHAUFFAG |             |
| 43    | 579122     | 1   | CLAVIJA NEGRA        | SOCKET BLACK         | DOVILLE NOIRE        |             |
| 44    | 579121     | 1   | CLAVIJA ROJA         | SOCKET RED           | DOVILLE ROUGE        |             |
| 45    | 163530     | 1   | INTERRUP LIMPIAP     | WIPER MOTOR SWIT     | INTERRUP DE ESSU     |             |
|       | 163535     | 1   | INTERRUP LIMPIAP ESP | WIPER MOTOR SWIT SPE | INTERRUP DE ESSU SPE |             |
| 46    | 163518     | 1   | INTERRUPTOR LUCES    | L 6TH SWITCH         | INTERRUPTEUR DE LUMI |             |
| 47    | 57916962   | 1   | VELOCIMETRO 88       | SPEEDOMETER 88       | COMTEUR DE VITER 88  |             |
|       | 57917162   | 1   | VELOCIMETRO 109      | SPEEDOMETER 109      | COMTEUR FE VITES 109 |             |
| 48    | 127339     | 1   | CABLE VELOCIMETRO    | SPEEDOMETER CABLE    | CABLE COMPTEUR DE VI |             |
|       | 127550     | 1   | CABLE VELO CC 5 VELO | SPEEDOMET 6B 5 SPEED | CABLE COMPTE BV 5 VI |             |
| 49    | 78924      | 3   | TORNILLO             | SCREW                | VIS                  |             |
| 50    | 054959     | 3   | ARANDELA             | WASHER               | RONDELLE             |             |
| 51    | 240430     | 1   | ABRAZADERA           | CLAMP                | BRIDE                |             |
| 52    | 189469     | 1   | CLIF                 | CLIP                 | CLIP                 |             |
|       | 239600     | 1   | CLIP                 | CLIP                 | CLIP                 |             |
| 53    | 06860      | 4   | GOMA                 | RUBBER               | CAOUTCHOUC           |             |
| 54    | 182112     | 1   | TORNILLO             | SCREW                | VIS                  |             |
|       | 78227      | 1   | TORNILLO             | SCREW                | VIS                  |             |
| 55    | 3840       | 2   | ARANDELA             | WASHER               | RONDELLE             |             |
| 56    | 3074       | 1   | ARANDELA             | WASHER               | RONDELLE             |             |
| 57    | 181184     | 1   | TUERCA               | NUT                  | ECROU                |             |
| 58    | 184258     | 2   | TORNILLO             | BOLT                 | BOULON               |             |

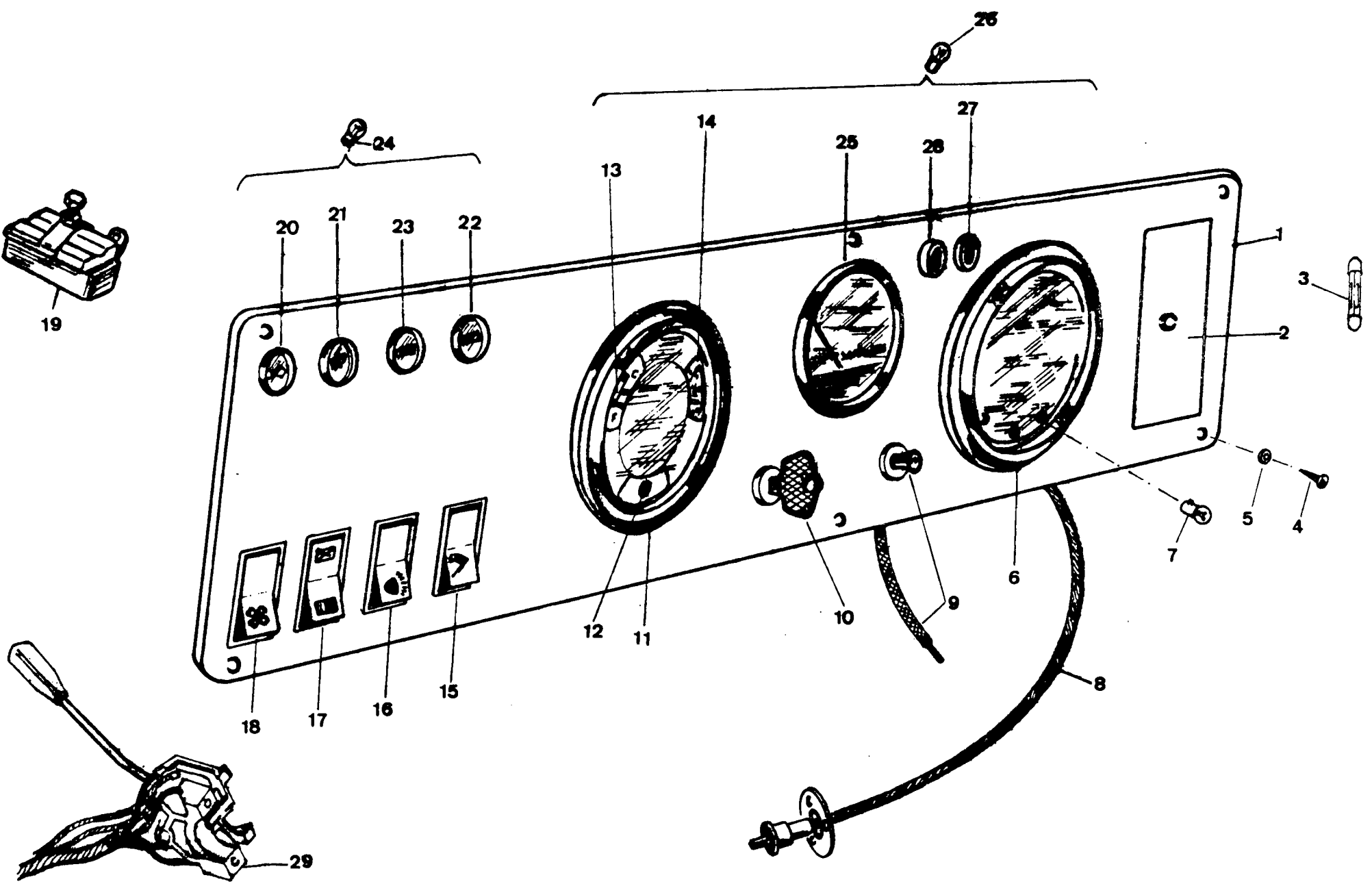

PUBLICACION N 890013  
EDICION N 1

GRUPO=12 PANEL DE INSTRUME  
GROUP=12 INSTRUMENT PANEL  
GROUPE=12 PANNEAUX ET INDIC

SUBGRUPO=PANEL DE INST 88 LIG  
SUBGROUP=INSTRUMENT PA 88 LIG  
SUBGROUPE=PANNEAUX ET 1 88 LIG

| N.FIG<br>PLATE<br>N.FIG | N.PIEZA<br>PARTNUMBER<br>N.PIECE | CAN<br>QTY<br>OUT | DENOMINACION         | DESCRIPTION          | DENOMINATION         | C H A S I S |
|-------------------------|----------------------------------|-------------------|----------------------|----------------------|----------------------|-------------|
| 1                       | 172610                           | 1                 | PANEL DE INSTRUMENTO | INSTRUMENTS PANEL    | PANNEAUX O INSTRUMEN |             |
| 2                       | 165537                           | 1                 | CAJA FUSIBLES        | FUSE BOX             | BOITE DE FUSIBLES    |             |
| 3                       | 161837                           | 3                 | FUSIBLE 8 A          | FUSE 8 A             | FUSIBLES 8 A         |             |
|                         | 164898                           | 3                 | FUSIBLE 10 A         | FUSE 10 A            | FUSIBLES 10 A        |             |
|                         | 166217                           | 1                 | FUSIBLE 5 A          | FUSE 5 A             | FUSIBLES 5 A         |             |
| 4                       | 78177                            | 6                 | TORNILLO             | SCREW                | VIS                  |             |
| 5                       | 3685                             | 6                 | ARANDELA             | WASHER               | RONDELLE             |             |
| 6                       | 579160G2                         | 1                 | VELOCIMETRO          | SPEEDOMETER          | COMTEUR DE VITESSE   |             |
| 7                       | 160559                           | 3                 | BOMBILLA 24 V        | LAMP 24 V            | LAMPE 24 V           |             |
| 8                       | 623055                           | 1                 | CABLE VELOCIMETRO    | SPEEDOMETER          | CABLE COMPTEUR DE VI |             |
| 9                       | 164621                           | 1                 | ESANGULADOR G        | STARTING SHUTLER P   | VALET DE DEPART E    |             |
|                         | 164627                           | 1                 | CABLE PARE D         | STOP CABLE D         | CABLE DE ARRET D     |             |
| 10                      | 531532F1                         | 1                 | LLAVE DE ARRANQUE G  | IGNITION KEY G       | CLE DE COMMUTATEUR G |             |
|                         | 589013F1                         | 1                 | LLAVE DE ARRANQUE D  | IGNITION KEY D       | CLE DE COMMUTATEUR D |             |
| 11                      | 161572                           | 1                 | PANEL COMBINADO      | GANGE PANEL          | TABLIER COMPLETE     |             |
| 12                      | 555827                           | 1                 | INDICADOR CARGA      | WARNING LIGHT CHARGE | INDICATEUR DE CHARGE |             |
| 13                      | 193344                           | 1                 | INDICADOR TEMPERATUR | TEMPERATURE GANGE IN | INDICATEUR DE TEMPER |             |
| 14                      | 555835K1                         | 1                 | INDICADOR COMBUSTIBL | FUEL GANGE INDICATOR | INDICATEUR DE CARBUR |             |
| 15                      | 163535                           | 1                 | INTERRUP LIMPIAPARAB | WIPER MOTOR SWITCH   | INTERRUP DE ESSVIE G |             |
| 16                      | 712085                           | 1                 | INTERRUP LUCES 3 P   | LIGHT SEITCH 3 P     | INTERRUP DE LUMI 3 P |             |
| 17                      | 163531                           | 1                 | TAPON                | PLUG                 | BOUCHON              |             |
|                         | 163536                           | 1                 | INTERRUP DOBLE DEPOS | DOUBLE FUEL TANK SWI | INTERRUP DOUBLE RESE |             |
| 18                      | 712093                           | 1                 | INTERRUP CALEFACCION | HEATING SWITCH       | INTERRUP DE CHAUFFAG |             |
| 19                      | 563318                           | 1                 | INTERRUP ESTRANGULAD | STARTING SWITCH      | INTERRUP DE VALET DE |             |
| 20                      | 718363                           | 1                 | INDICADOR INTERMITEN | DIRECTION INDICATOR  | INDICATEUR DE DIRECT |             |
| 21                      | 718109                           | 1                 | INDICADOR FRENOS     | BRAKES INDICATOR     | INDICATEUR DE CREINS |             |
| 22                      | 718110                           | 1                 | INDICADOR DEPOSITO   | FUEL TANK INDICATOR  | INDICATEUR RESERVOIR |             |
| 23                      | 301346                           | 1                 | TAPON                | PLUG                 | BOUCHON              |             |
| 24                      | 161278                           | 3                 | BOMBILLA             | LAMP                 | LAMPE                |             |
| 25                      | 589137F1                         | 1                 | INDICADOR PRESION AC | OIL PRESURE INDICATO | INDIC PRESION D HUIL |             |
| 26                      | 232590E1                         | 7                 | BOMBILLA             | LAMP                 | LAMPE                |             |
| 27                      | 579121                           | 1                 | CLAVIJA ROJA         | SOCKET RED           | DOVILLE ROUGE        |             |
| 28                      | 579122                           | 1                 | CLAVIJA NEGRA        | SOCKET BLACK         | DOVILLE NOIRE        |             |
| 29                      | 575383K1                         | 1                 | MANDO DE LUCES       | SWITCH FOR FLASHER   | INTERRUPTEUR DE LUMI |             |

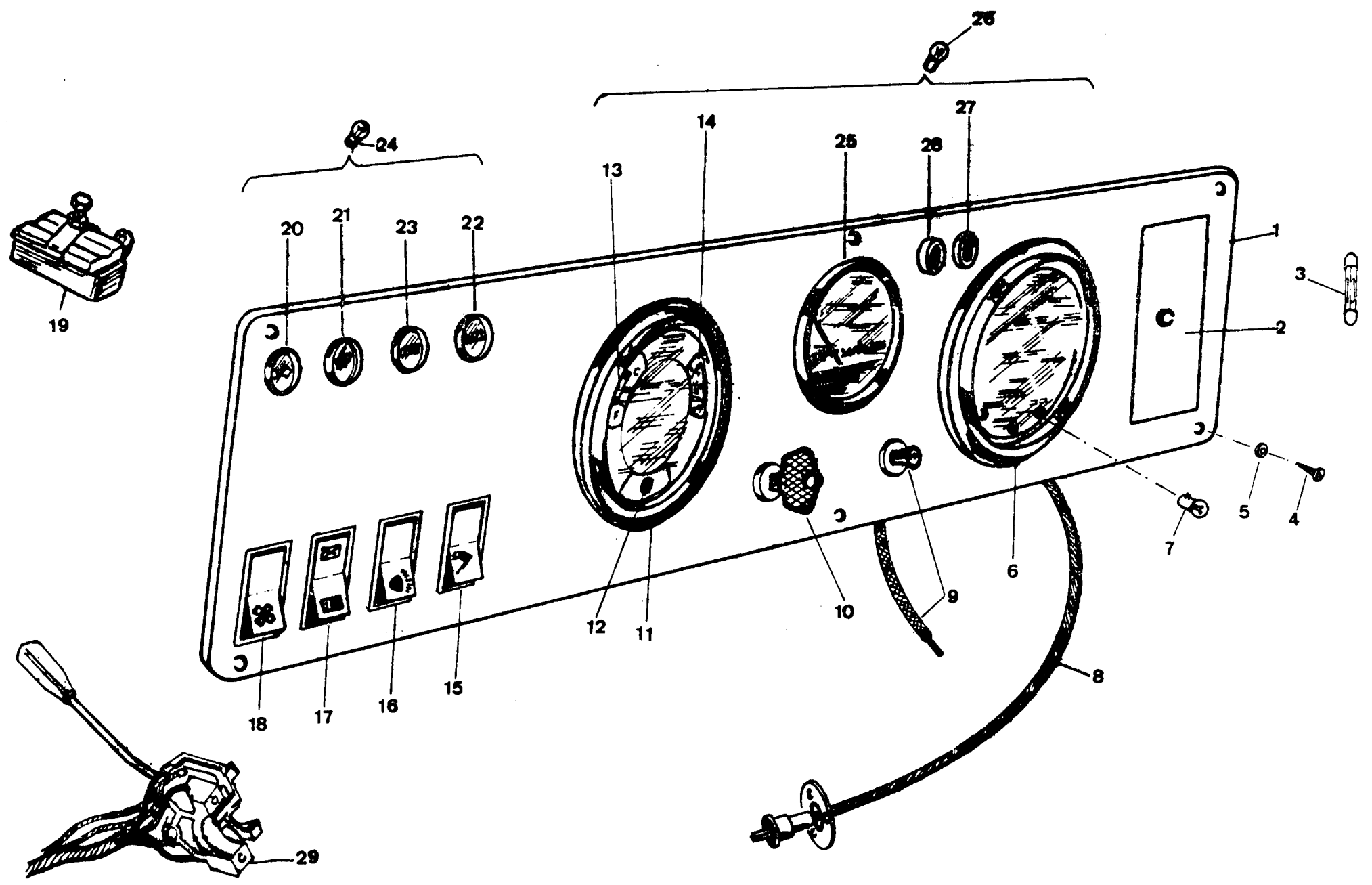



PUBLICACION N 890813  
EDICION N 1

GRUPO=12 PANEL DE INSTRUME  
GRUPO=12 INSTRUMENT PANEL  
GRUPO=12 PANNEAUX ET INDIC

SUBGRUPO=PAÑEL DE INST 88 LIG  
SUBGRUPO=INSTRUMENT PA 88 LIG  
SUBGRUPO=PANNEAUX ET I 88 LIG

| N.FIG | N.PIEZA    | CAN |              |             |              |             |
|-------|------------|-----|--------------|-------------|--------------|-------------|
| PLATE | PARTNUMBER | QTY |              |             |              |             |
| N.FIG | N.PIECE    | OUT | DENOMINACION | DESCRIPTION | DENOMINATION | C H A S I S |
| 30    | 278010     | 1   | CLIP         | CLIP        | CLIP         |             |
| 31    | 240431     | 1   | ABRAZADERA   | CLAMP       | ETRIER       |             |
| 32    | 06860      | 4   | GOMA         | RUBBER      | CAOUTCHOUC   |             |
| 33    | 78227      | 1   | TORNILLO     | SCREW       | VIS          |             |
| 34    | 189469     | 2   | CLIP         | CLIP        | CLIP         |             |
|       | 240407     | 1   | CLIP         | CLIP        | CLIP         |             |
| 35    | 250957     | 3   | TORNILLO     | SCREW       | VIS          |             |
| 36    | 054959     | 3   | ARANDELA     | WASHER      | RONDILLE     |             |